

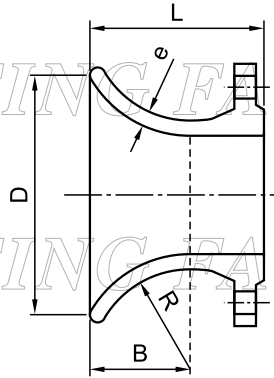

Flange Bellmouths



Unit : mm

Nominal size DN	e	L	D	B	R	Mass with flange (Kg)		
						PN 10	PN 16	PN 25
80	7.0	135	160	80	100	5.2	5.2	5.6
100	7.2	140	185	85	106	6.3	6.3	6.8
150	7.8	155	245	95	119	10.1	10.1	11.1
200	8.4	170	310	110	137	14.9	14.7	16.8
250	9.0	190	370	120	150	21.4	21.0	24.9
300	9.6	210	435	135	169	29.4	29.0	34.6
350	10.2	225	495	145	181	35.9	39.0	47.3
400	10.8	245	560	160	200	45.4	51.0	62.3
450	11.4	260	620	170	212	55.1	63.0	73.9
500	12.0	280	685	185	231	67.3	82.5	94.2
600	13.2	300	810	210	262	97.2	122.0	137.9
700	14.4	340	945	225	281	137.2	154.0	187.0
800	15.6	380	1055	240	300	183.8	203.0	252.2
900	16.8	420	1165	255	319	239.1	263.0	323.4
1000	18.0	440	1290	270	337	297.5	339.0	416.8
1100	19.2	465	1400	285	357	374.0	409.0	481.9
1200	20.4	490	1515	300	376	450.7	515.0	614.5
1400	22.8	515	1725	305	400	540.9	609.0	761.2
1600	25.2	540	1945	310	400	724.0	826.0	1003.1